

PRODUCT DATA SHEET

INSULATED BULLET FEMALE DISCONNECTS



DESCRIPTION

Insulated Bullet Female Disconnects streamline shapes easily through tight spaces because they are not much larger than the wire itself. allows them to pass. The connection can be connected and disconnected as needed.

FEATURES

- | | |
|-------------------------|--------------------------------------|
| - Standard | : DIN 46237 |
| - Material | : Brass, Tin Plating, Copper Ferrule |
| - Insulation | : PVC |
| - Operating Temperature | : Maximum From 75° to 600 Volts |

MARKINGS



- It complies with RoHS standards.
- It complies with UKAS Quality Management standards.
- It complies with CE standards.
- It complies with UL standards.

PRODUCT DATA SHEET

INSULATED BULLET FEMALE DISCONNECTS

SECTIONS AND DIMENSIONS

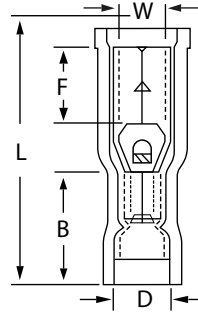

PRODUCT CODE	COLOUR	CABLE SECTION (mm ²)	DIMENSIONS (mm)				
			W	F	L	B	D
GBD - 1040	Red	0.50 - 1.50 mm ²	3.9	7.0	23.3	10.5	3.8
GBD - 2050	Blue	1.50 - 2.50 mm ²	4.9	7.0	23.3	10.5	4.7
GBD - 5050	Yellow	4.00 - 6.00 mm ²	4.9	7.0	25.1	12.5	6.2